

# 壁高欄配筋図(その1) S=1:30

## 左側 側面図

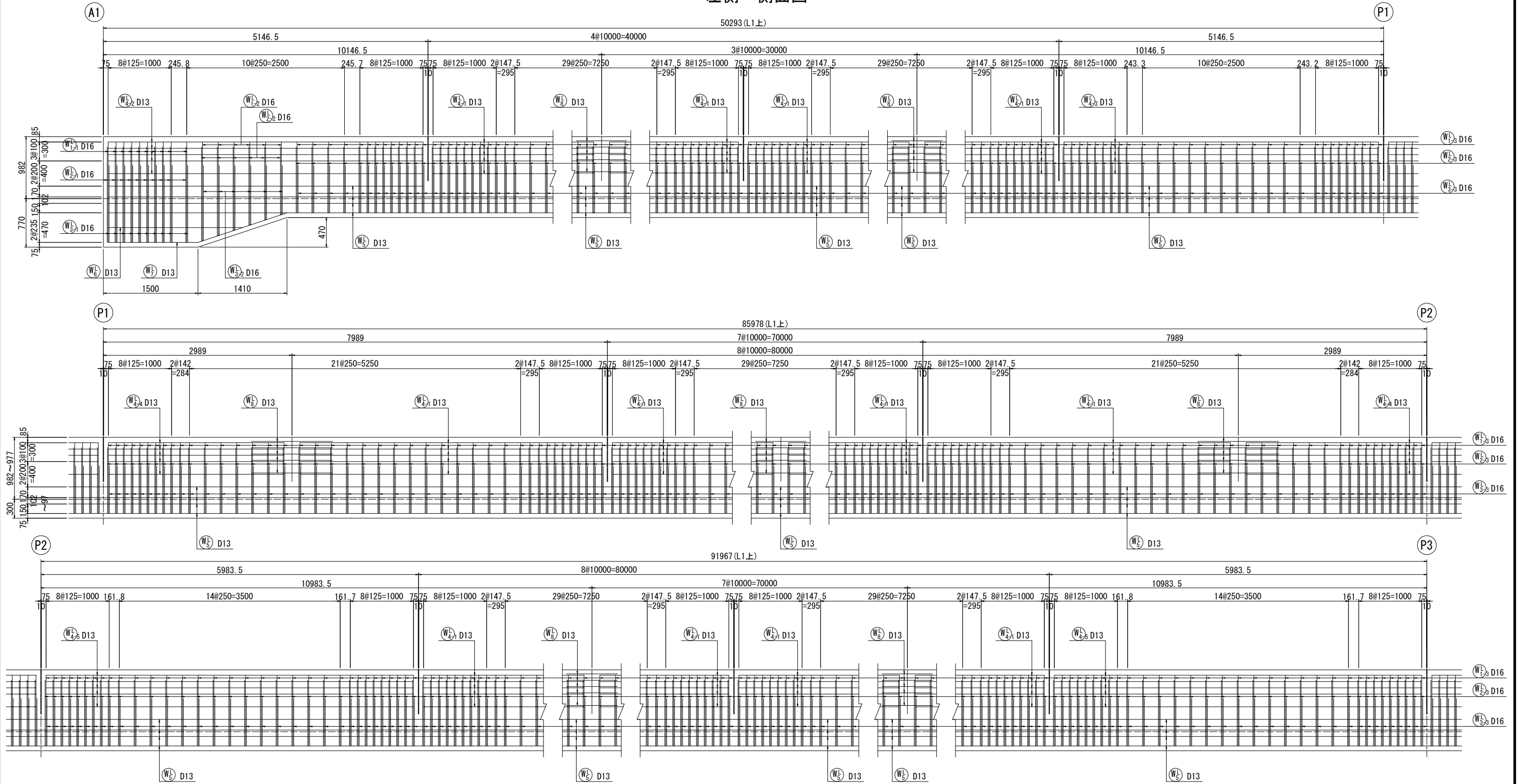

膨張目地詳細図

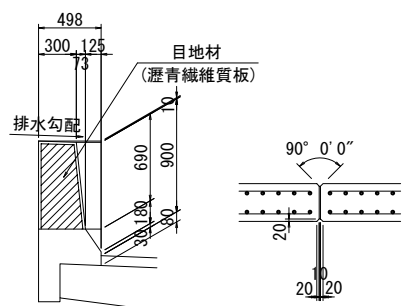

Vカット目地詳細図

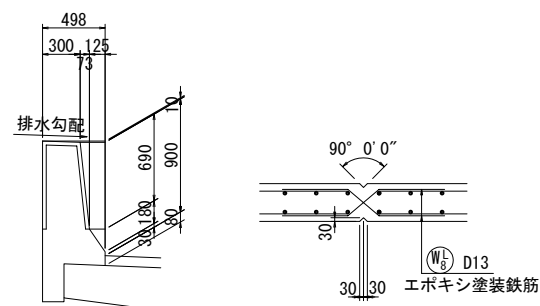

# 壁高欄配筋図(その2) S=1:30

## 左側 側面図

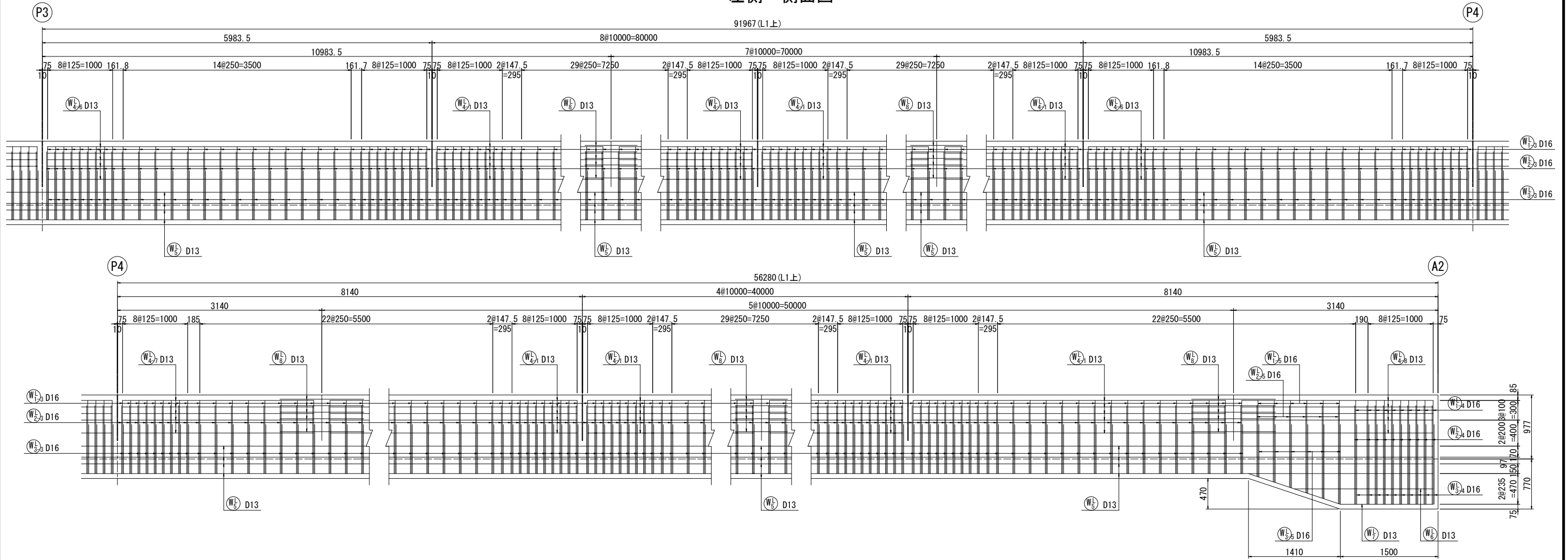

## 位置図 S=1:600

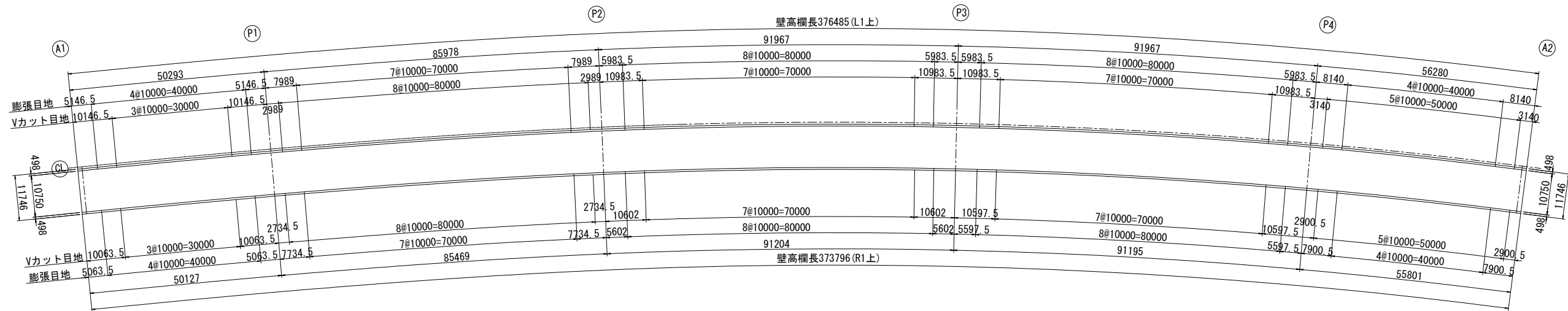

# 壁高欄配筋図(その3) S=1:30

## 右側 側面図

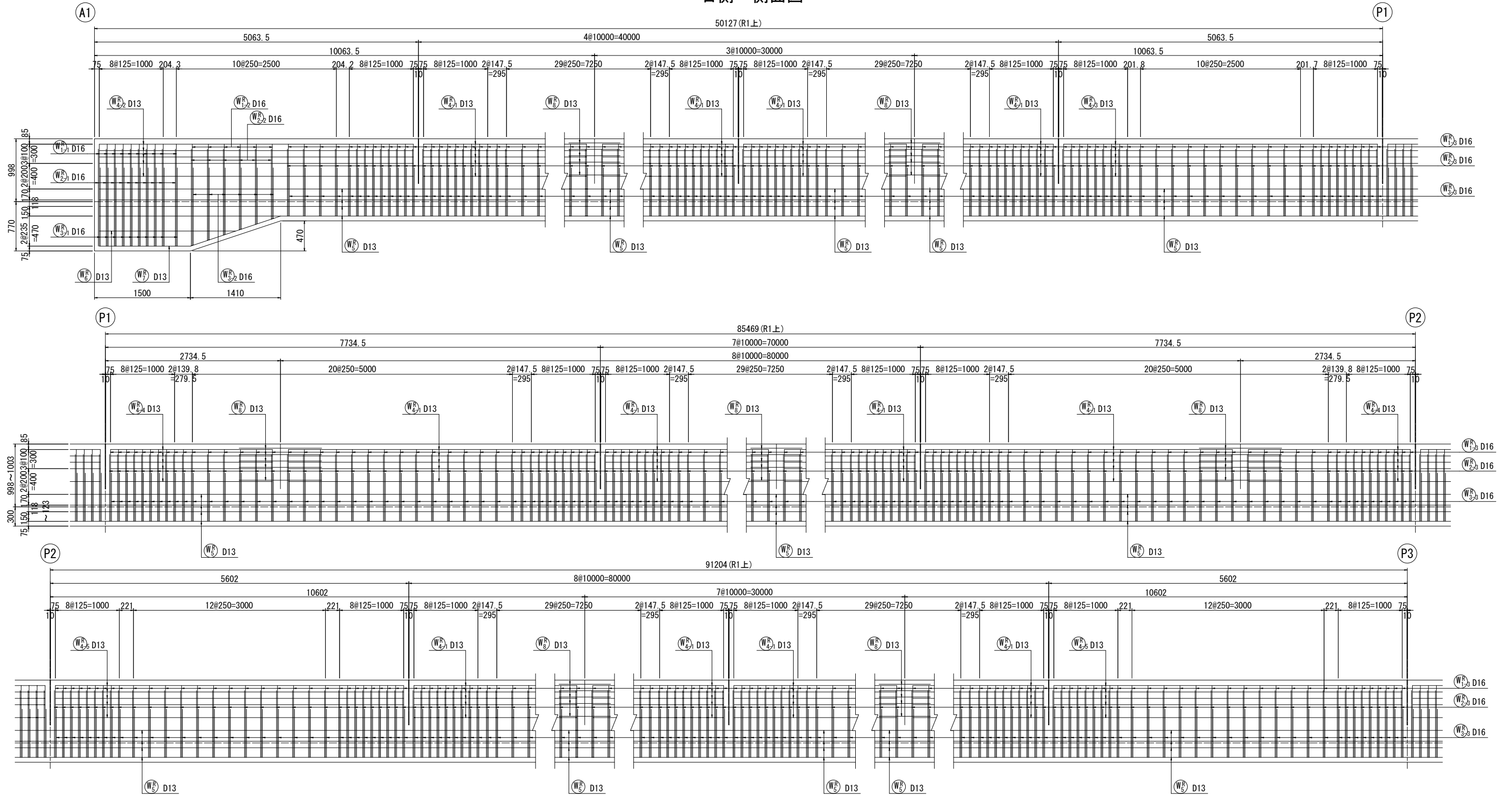

膨張目地詳細図

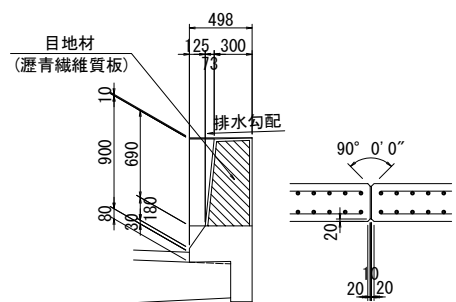

Vカット目地詳細図

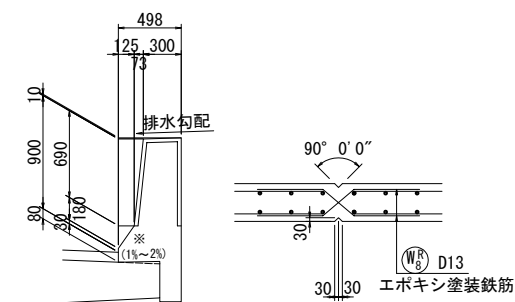

壁高欄配筋図(その4) S=1:30

右側 側面図

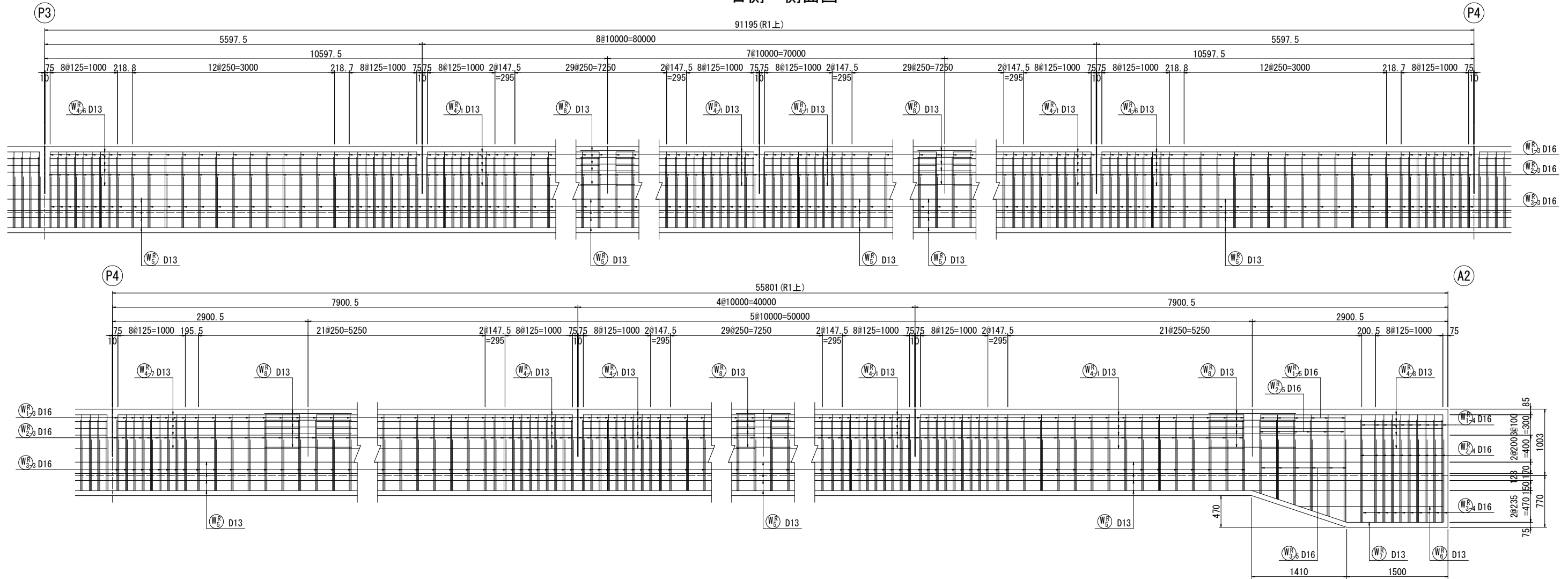

位置図 S=1:600

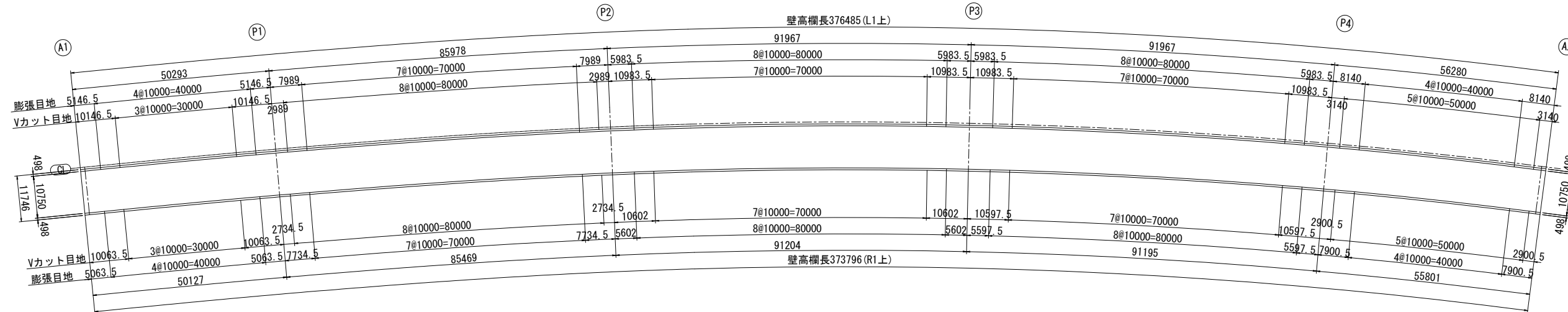

# 壁高欄配筋図(その5) S=1:30

## 断面図

標準部

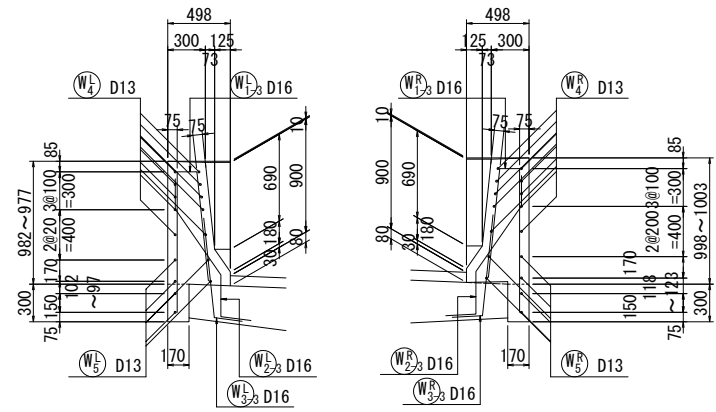

A1側桁端部(A2側桁端部)

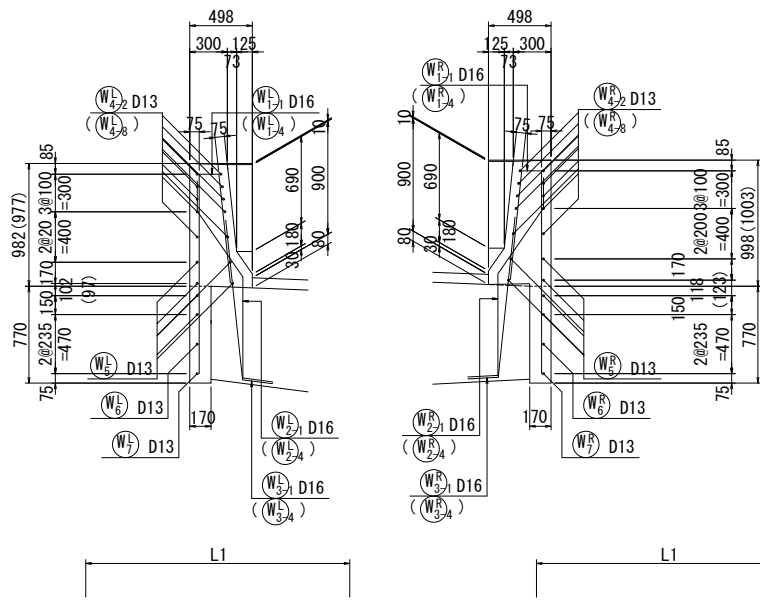

番号	n	L1	ΣL
4-1	660	4840	4840
4-2	10	4992	5000
4-3	10	4987	4990
4-4	20	2784	2790
4-5	20	5824	5830
4-6	20	5824	5830
4-7	10	2935	2940
4-8	10	2940	2940

番号	n	L1	ΣL
4-1	660	4840	4840
4-2	10	4909	4910
4-3	10	4904	4910
4-4	20	2530	2530
4-5	20	5442	5450
4-6	20	5438	5440
4-7	10	2696	2700
4-8	10	2701	2710

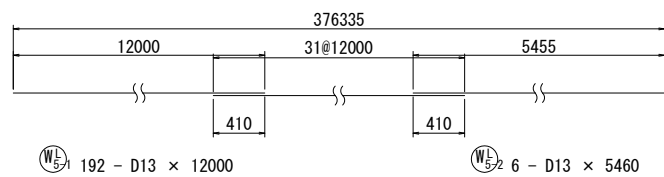

WL5-1 192 - D13 × 12000

WL5-2 6 - D13 × 5460

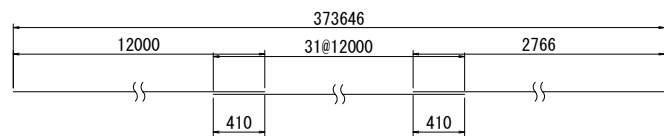

WL5-1 192 - D13 × 12000

WL5-2 6 - D13 × 2770

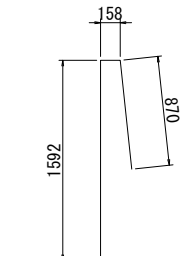

WL1-1 10 - D16 × 2620

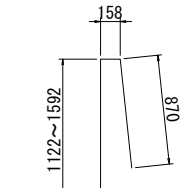

WL2-1 6 - D16 × 2390(平均長)

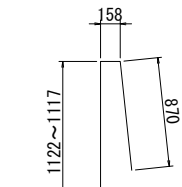

WL3-1 1876 - D16 × 2150(平均長)

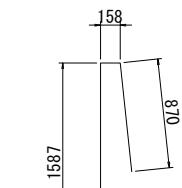

WL4-1 10 - D16 × 2620

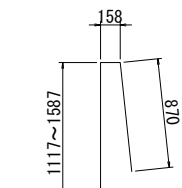

WL5-1 6 - D16 × 2380(平均長)

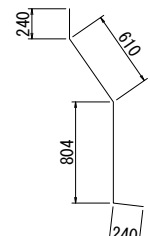

WL1-2 10 - D16 × 1900

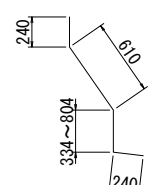

WL2-2 6 - D16 × 1660(平均長)

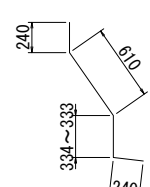

WL3-2 1876 - D16 × 1430(平均長)

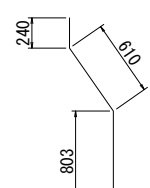

WL4-2 10 - D16 × 1900

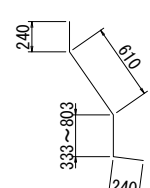

WL5-2 6 - D16 × 1660(平均長)

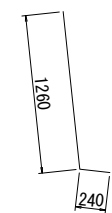

WL3-3 10 - D16 × 1500

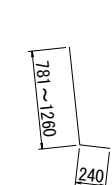

WL2-3 6 - D16 × 1270(平均長)

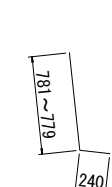

WL3-3 1876 - D16 × 1020(平均長)

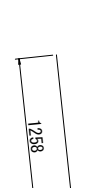

WL4-3 10 - D16 × 1500

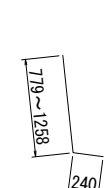

WL5-3 6 - D16 × 1260(平均長)

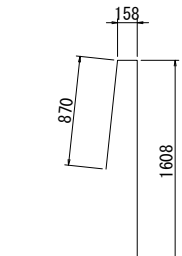

WL1-4 10 - D16 × 2640

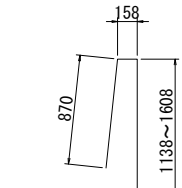

WL2-4 6 - D16 × 2410(平均長)

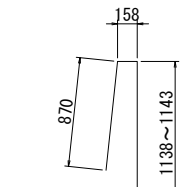

WL3-4 1864 - D16 × 2170(平均長)

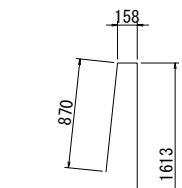

WL4-4 10 - D16 × 2650

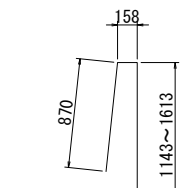

WL5-4 6 - D16 × 2410(平均長)

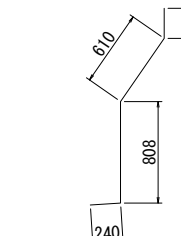

WL1-5 10 - D16 × 1900

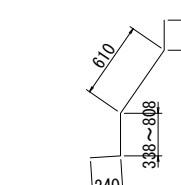

WL2-5 6 - D16 × 1670(平均長)

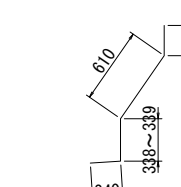

WL3-5 1864 - D16 × 1430(平均長)

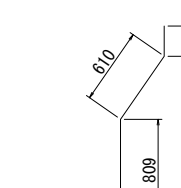

WL4-5 10 - D16 × 1900

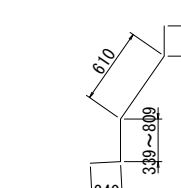

WL5-5 6 - D16 × 1670(平均長)

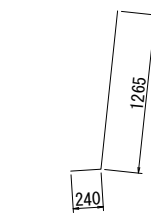

WL1-6 10 - D16 × 1510

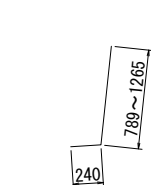

WL2-6 6 - D16 × 1270(平均長)

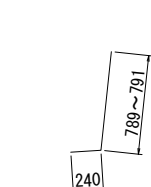

WL3-6 1864 - D16 × 1030(平均長)

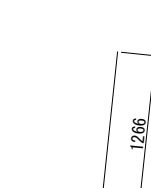

WL4-6 10 - D16 × 1510

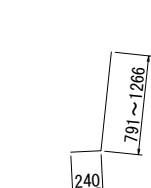

WL5-6 6 - D16 × 1270(平均長)

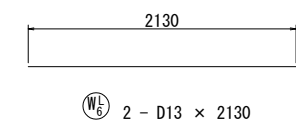

WL6-1 2 - D13 × 2130

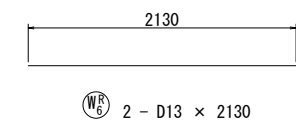

WL6-2 2 - D13 × 2130

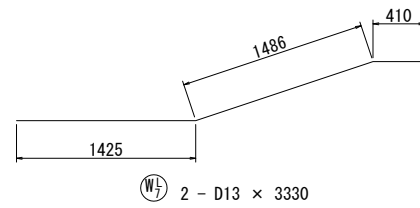

WL7-1 2 - D13 × 3330

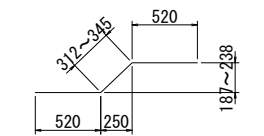

WL8-1 350 - D13 × 1370(平均長)  
(エポキシ塗装鉄筋)

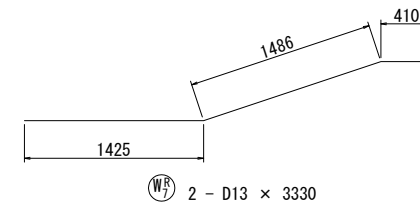

WL7-2 2 - D13 × 3330

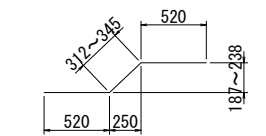

WL8-2 350 - D13 × 1370(平均長)  
(エポキシ塗装鉄筋)

# 壁高欄配筋図(その6)

鉄筋表(左側壁高欄)

種別	径	長さ (mm)	本数	単位質量 (kg/m)	1本当り質量 (kg)	質量 (kg)	形状	摘要
WL1-1	D16	2620	10	1.56	4.09	41	↑	
WL1-2	D16	2390	6	1.56	3.73	22	↑	(平均長)
WL1-3	D16	2150	1876	1.56	3.35	6285	↑	(平均長)
WL1-4	D16	2620	10	1.56	4.09	41	↑	
WL1-5	D16	2380	6	1.56	3.71	22	↑	(平均長)
WL2-1	D16	1900	10	1.56	2.96	30	↘	
WL2-2	D16	1660	6	1.56	2.59	16	↘	(平均長)
WL2-3	D16	1430	1876	1.56	2.23	4183	↘	(平均長)
WL2-4	D16	1900	10	1.56	2.96	30	↘	
WL2-5	D16	1660	6	1.56	2.59	16	↘	(平均長)
WL3-1	D16	1500	10	1.56	2.34	23	↘	
WL3-2	D16	1270	6	1.56	1.98	12	↘	(平均長)
WL3-3	D16	1020	1876	1.56	1.59	2983	↘	(平均長)
WL3-4	D16	1500	10	1.56	2.34	23	↘	
WL3-5	D16	1260	6	1.56	1.97	12	↘	(平均長)
WL4-1	D13	4840	660	0.995	4.82	3181	—	
WL4-2	D13	5000	10	0.995	4.98	50	—	
WL4-3	D13	4990	10	0.995	4.97	50	—	
WL4-4	D13	2790	20	0.995	2.78	56	—	
WL4-5	D13	5830	20	0.995	5.80	116	—	
WL4-6	D13	5830	20	0.995	5.80	116	—	
WL4-7	D13	2940	10	0.995	2.93	29	—	
WL4-8	D13	2940	10	0.995	2.93	29	—	
WL5-1	D13	12000	192	0.995	11.94	2292	—	
WL5-2	D13	5460	6	0.995	5.43	33	—	
WL6	D13	2130	2	0.995	2.12	4	—	
WL7	D13	3330	2	0.995	3.31	7	↘	
19702 kg								
エポキシ塗装鉄筋								
WL8	D13	1370	350	0.995	1.36	476	↘	(平均長)
476 kg								
普通鉄筋      エポキシ塗装鉄筋      合計								
D16	13739	kg	-	kg	13739	kg		
D13	5963	kg	476	kg	6439	kg		
合計	19702	kg	476	kg	20178	kg		

鉄筋表(右側壁高欄)

種別	径	長さ (mm)	本数	単位質量 (kg/m)	1本当り質量 (kg)	質量 (kg)	形状	摘要
WR1-1	D16	2640	10	1.56	4.12	41	↑	
WR1-2	D16	2410	6	1.56	3.76	23	↑	(平均長)
WR1-3	D16	2170	1864	1.56	3.39	6319	↑	(平均長)
WR1-4	D16	2650	10	1.56	4.13	41	↑	
WR1-5	D16	2410	6	1.56	3.76	23	↑	(平均長)
WR2-1	D16	1900	10	1.56	2.96	30	↘	
WR2-2	D16	1670	6	1.56	2.61	16	↘	(平均長)
WR2-3	D16	1430	1864	1.56	2.23	4157	↘	(平均長)
WR2-4	D16	1900	10	1.56	2.96	30	↘	
WR2-5	D16	1670	6	1.56	2.61	16	↘	(平均長)
WR3-1	D16	1510	10	1.56	2.36	24	↘	
WR3-2	D16	1270	6	1.56	1.98	12	↘	(平均長)
WR3-3	D16	1030	1864	1.56	1.61	3001	↘	(平均長)
WR3-4	D16	1510	10	1.56	2.36	24	↘	
WR3-5	D16	1270	6	1.56	1.98	12	↘	(平均長)
WR4-1	D13	4840	660	0.995	4.82	3181	—	
WR4-2	D13	4910	10	0.995	4.89	49	—	
WR4-3	D13	4910	10	0.995	4.89	49	—	
WR4-4	D13	2530	20	0.995	2.52	50	—	
WR4-5	D13	5450	20	0.995	5.42	108	—	
WR4-6	D13	5440	20	0.995	5.41	108	—	
WR4-7	D13	2700	10	0.995	2.69	27	—	
WR4-8	D13	2710	10	0.995	2.70	27	—	
WR5-1	D13	12000	192	0.995	11.94	2292	—	
WR5-2	D13	2770	6	0.995	2.76	17	—	
WR6	D13	2130	2	0.995	2.12	4	—	
WR7	D13	3330	2	0.995	3.31	7	↘	
19688 kg								
エポキシ塗装鉄筋								
WR8	D13	1370	350	0.995	1.36	476	↘	(平均長)
476 kg								
普通鉄筋      エポキシ塗装鉄筋      合計								
D16	13769	kg	-	kg	13769	kg		
D13	5919	kg	476	kg	6395	kg		
合計	19688	kg	476	kg	20164	kg		